

Rez de chaussée

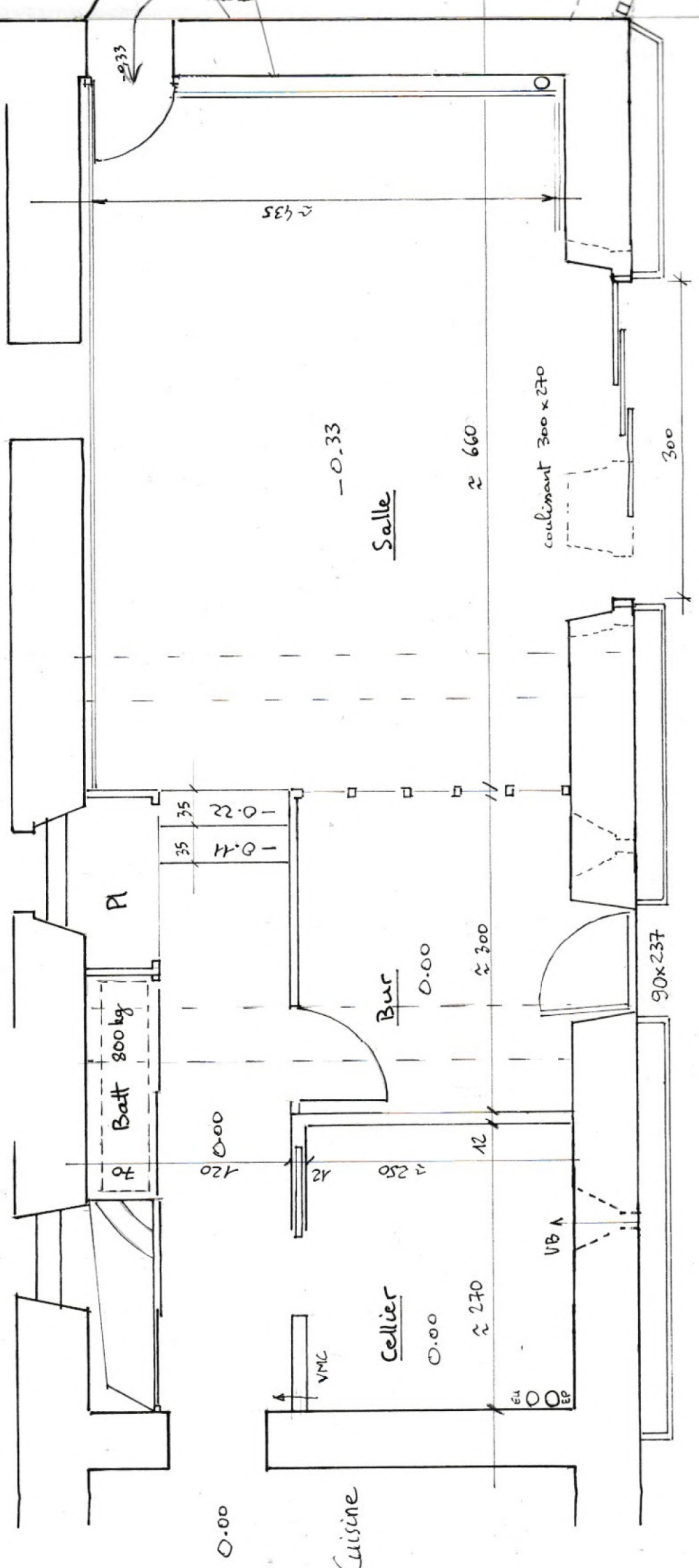

Rez de chaussée

Salle

Etage

-0.33

≈ 660

coulissant 300 x 270

300

≈ 435

≈ 333

traitement acoustique
trasseaux + lame minérale

Atelier -0.42

90 x 270

EW 44/10

234

0.42

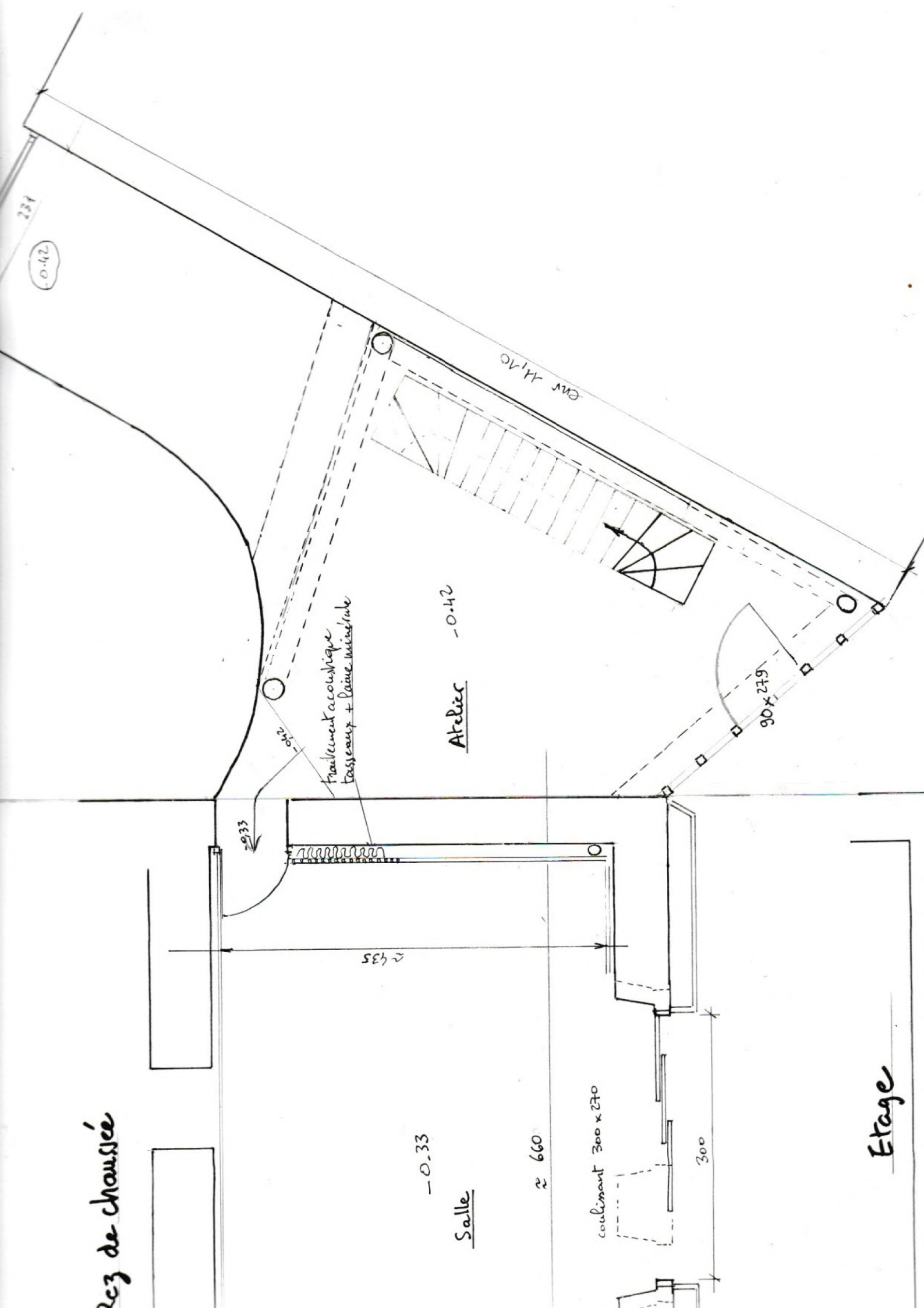

Etage

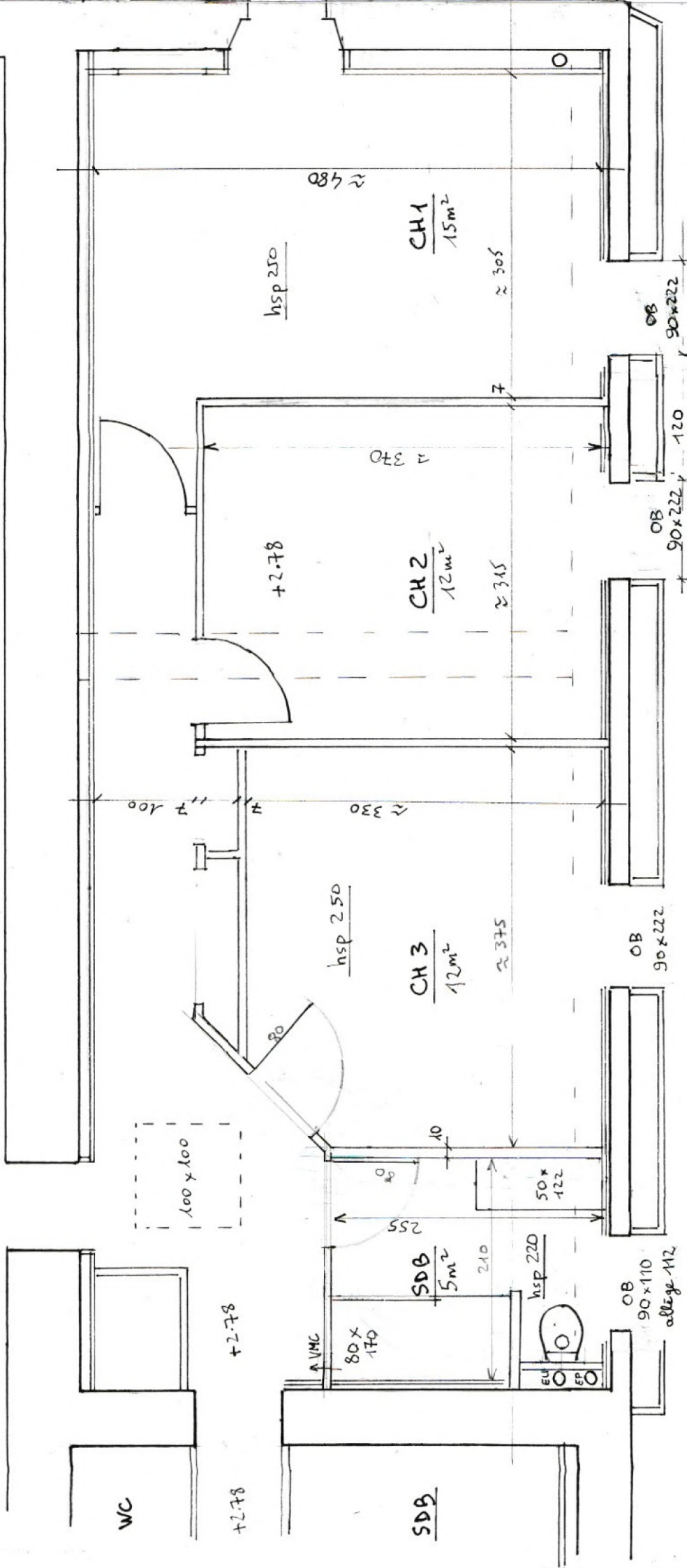

Etage

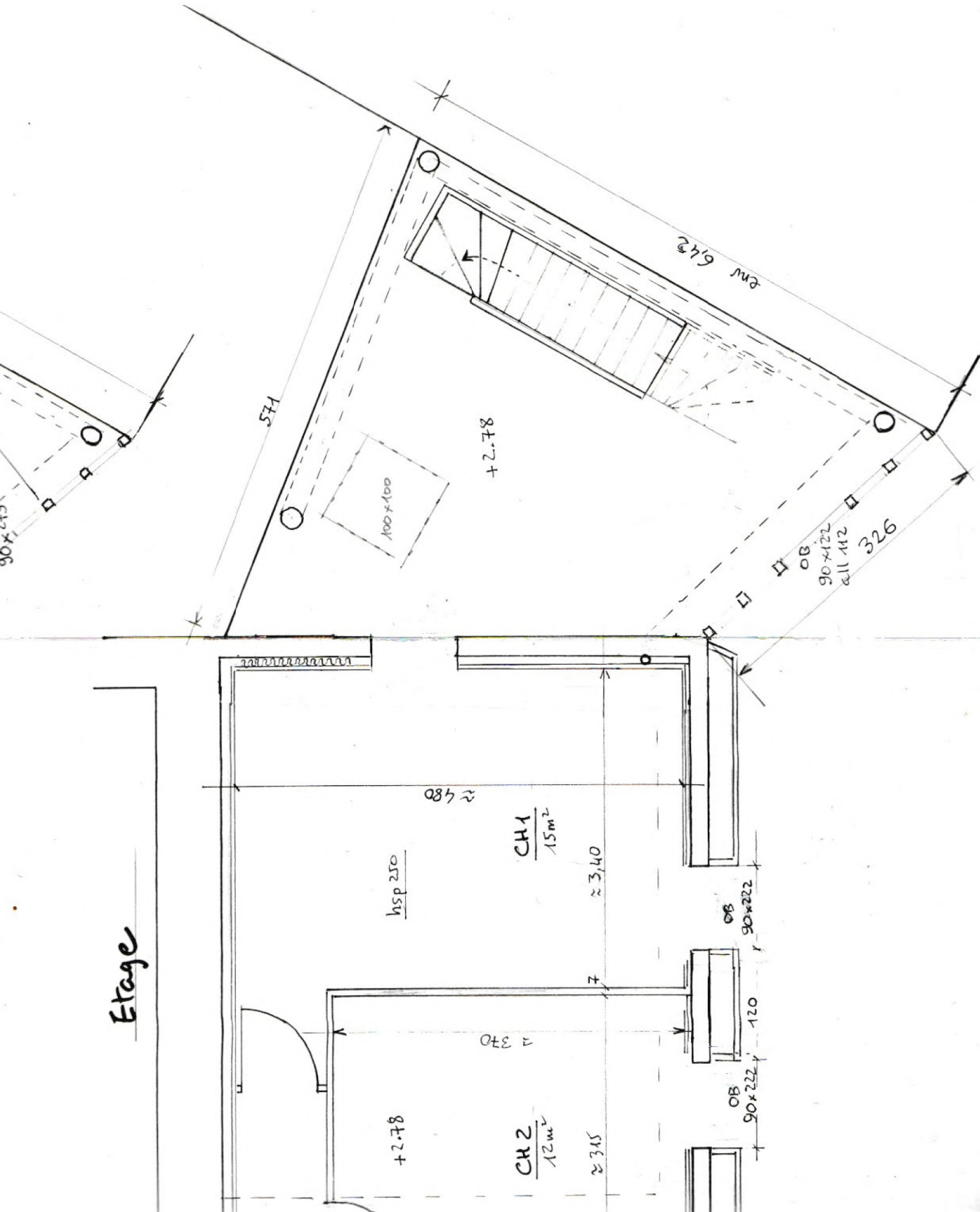

Terrasse

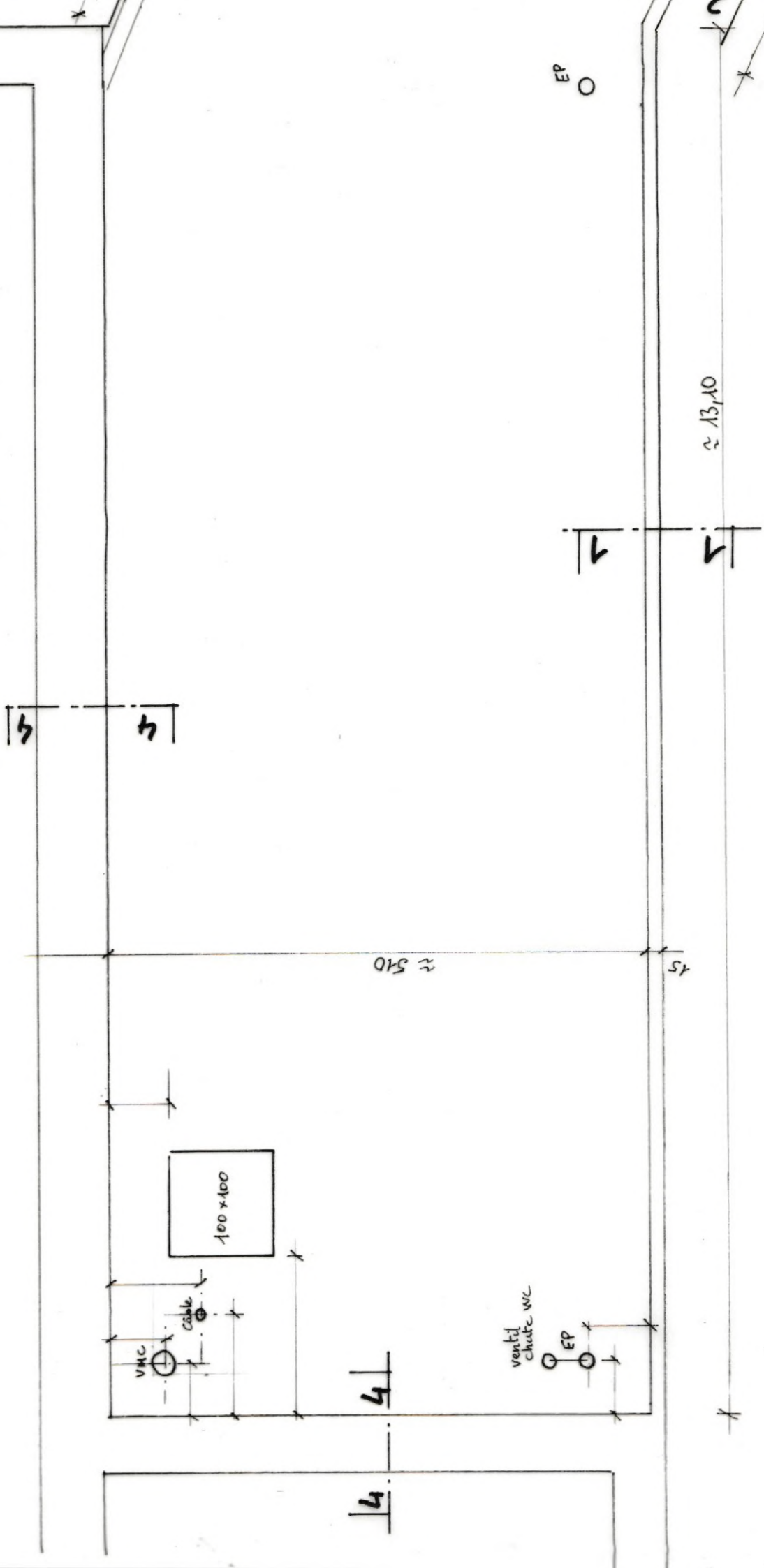

Terrasse

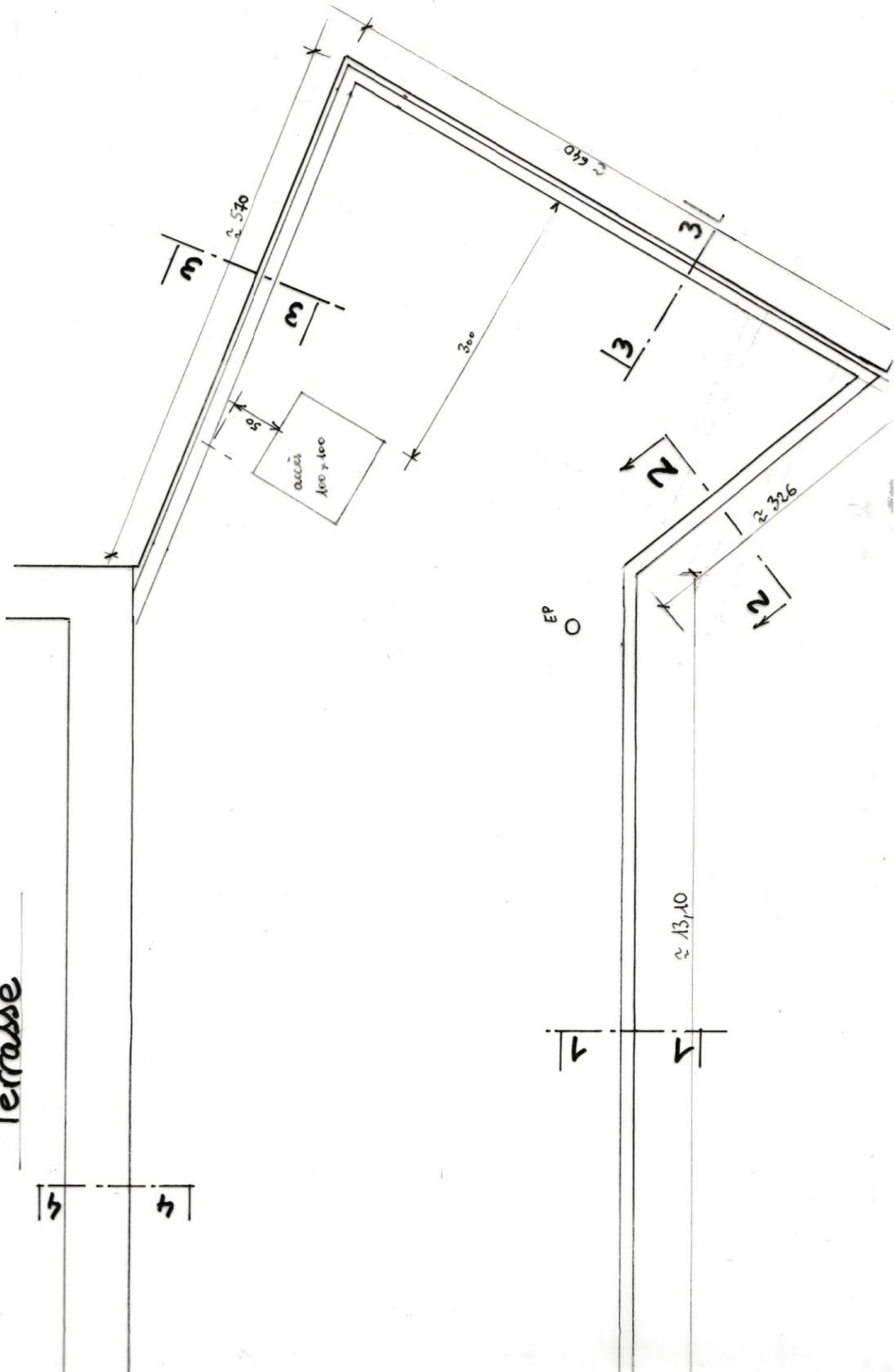

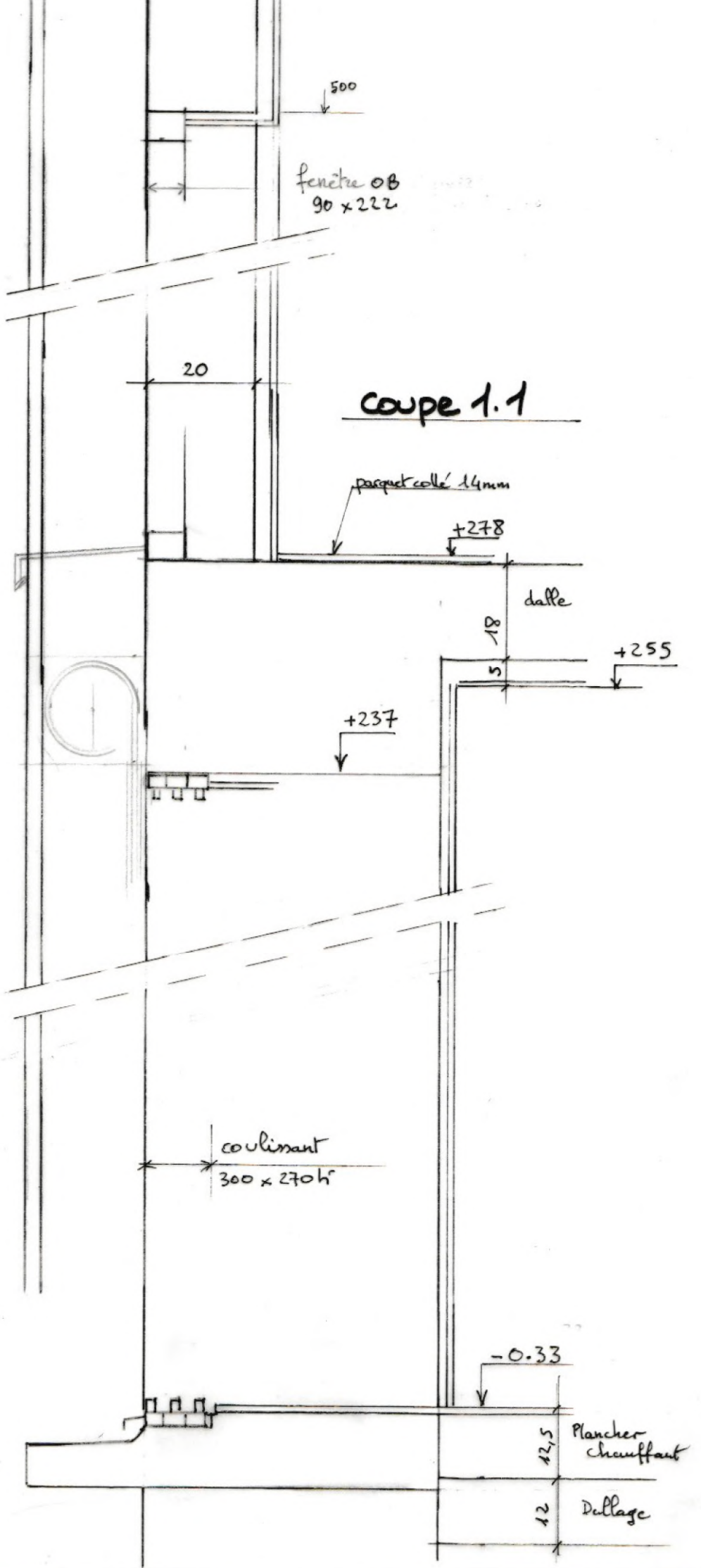

fenêtre OB
90 x 222

coupe 1.1

parquet collé 14mm

dalle

coulissant
300 x 270 h

Plancher
chauffant

Dallage

12,5

12

-0.33

+278

+237

+255

20

500

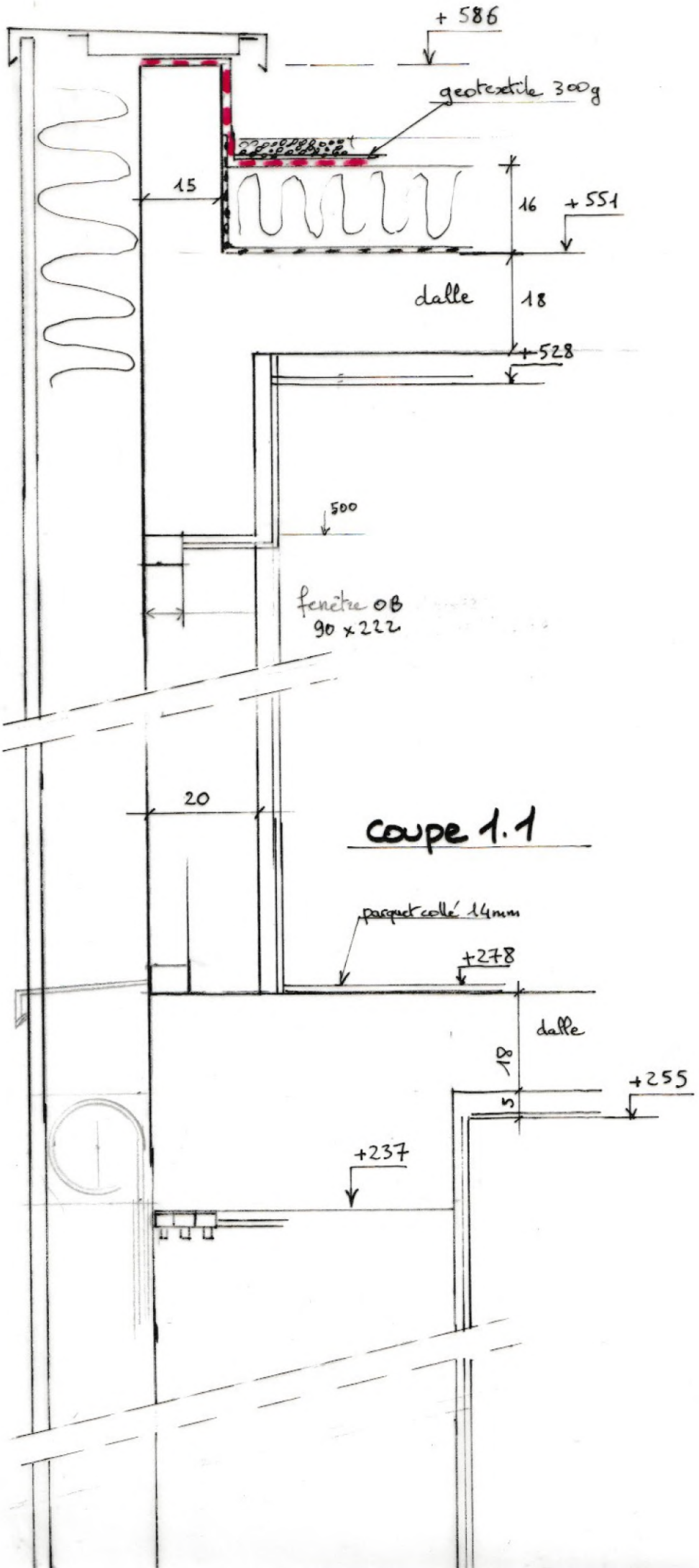

coupe 1.1

geotextile 300g

dalle

fenêtre OB
90 x 222

parquet collé 14mm

dalle

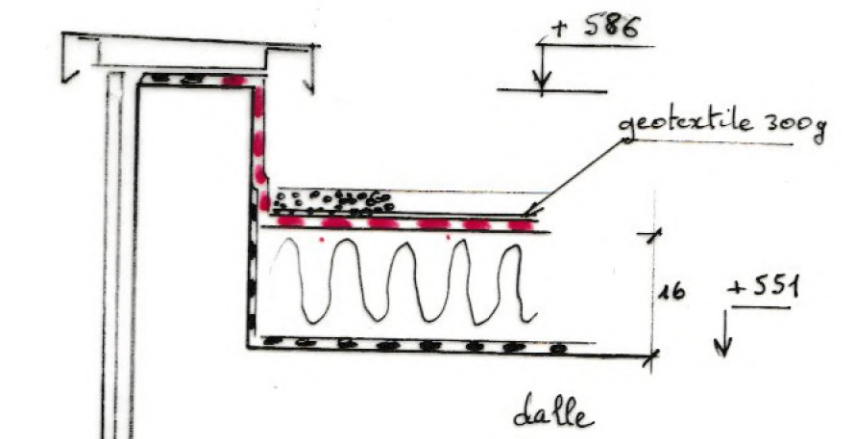

coupe 2.2

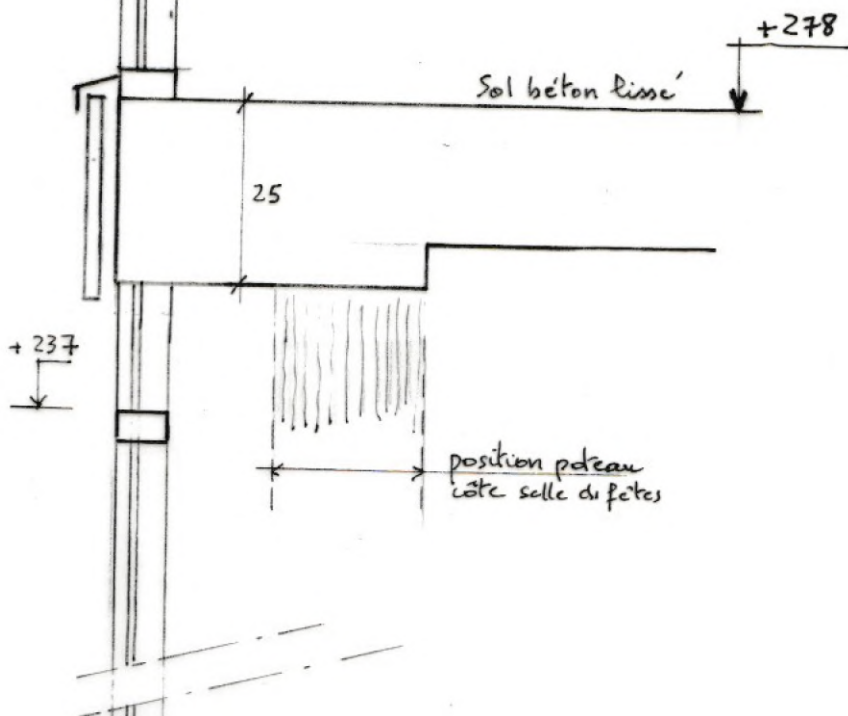

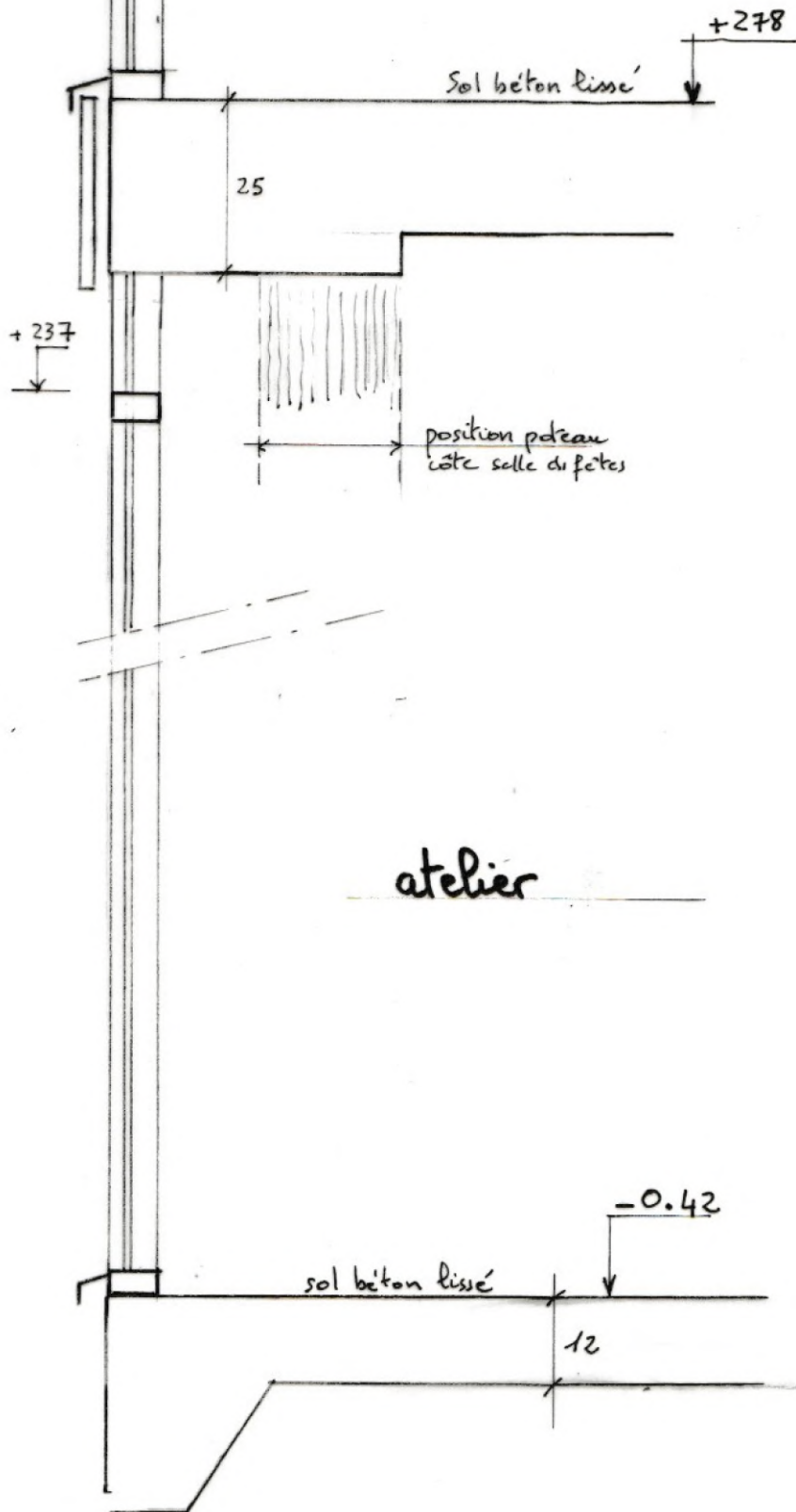

+278

sol béton lissé

25

+237

position poteau
côté salle de fêtes

atelier

-0.42

sol béton lissé

12

556

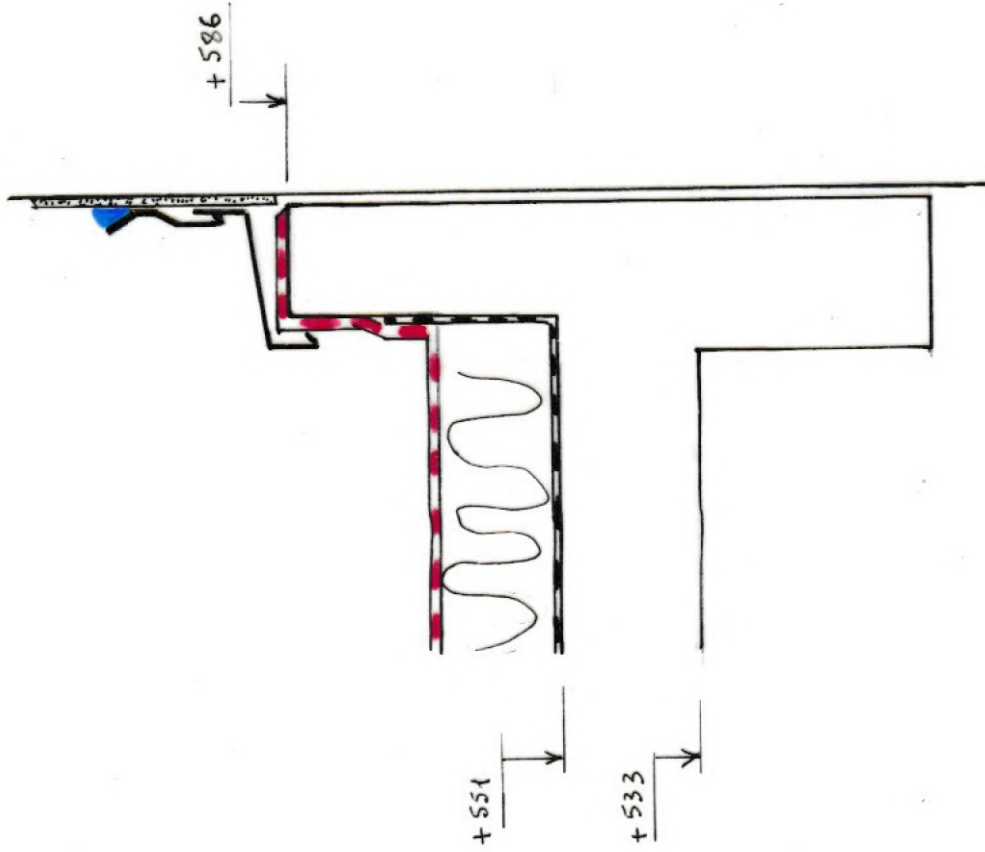

coupe 3.3

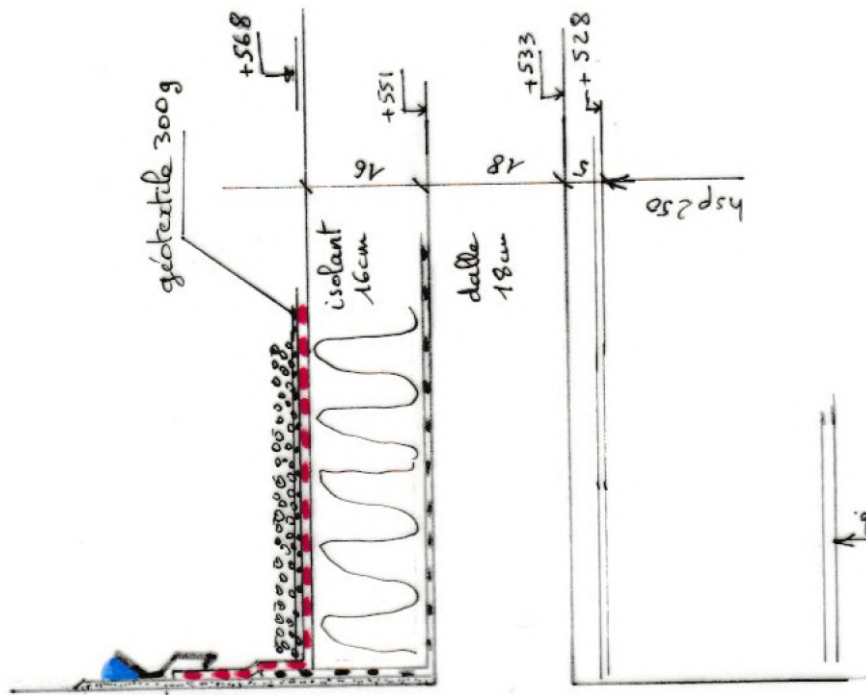

coupe 4.4

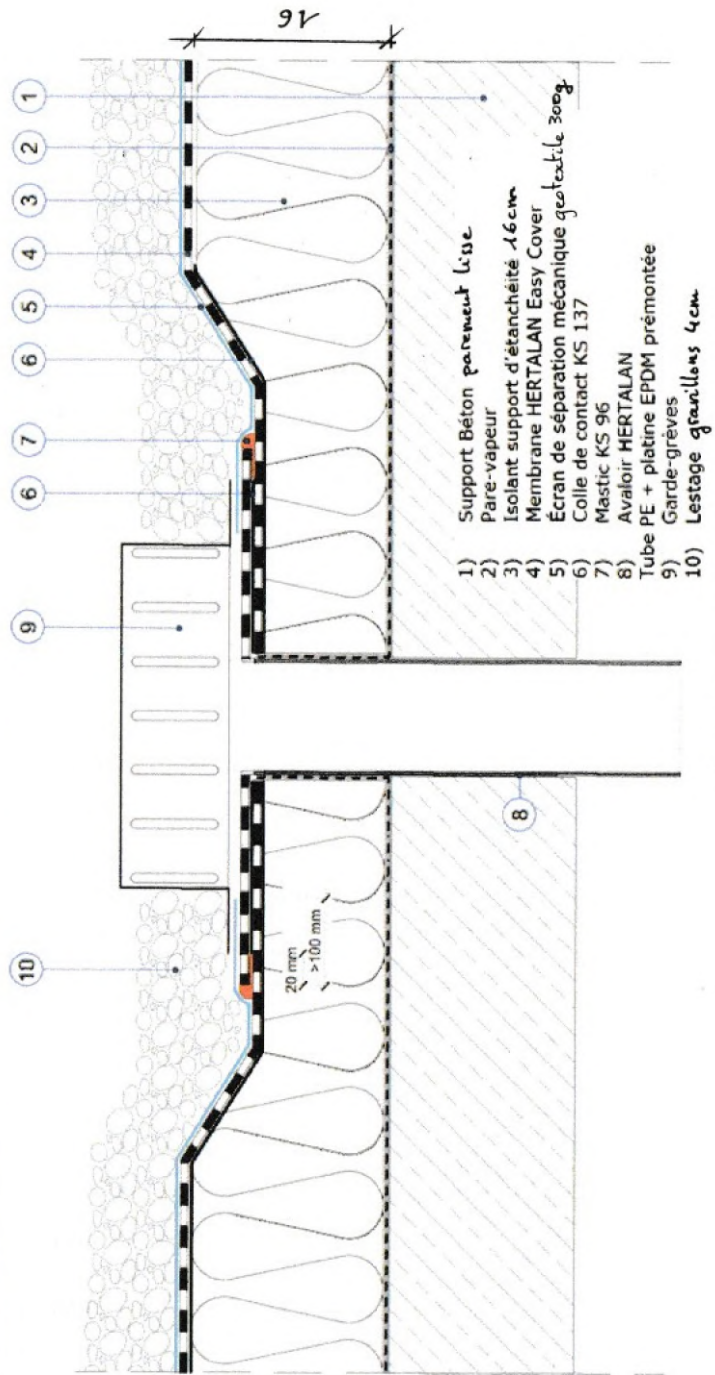

Évacuation d'eaux pluviales

FACADE JARDIN

1cm/m
27/05/2024

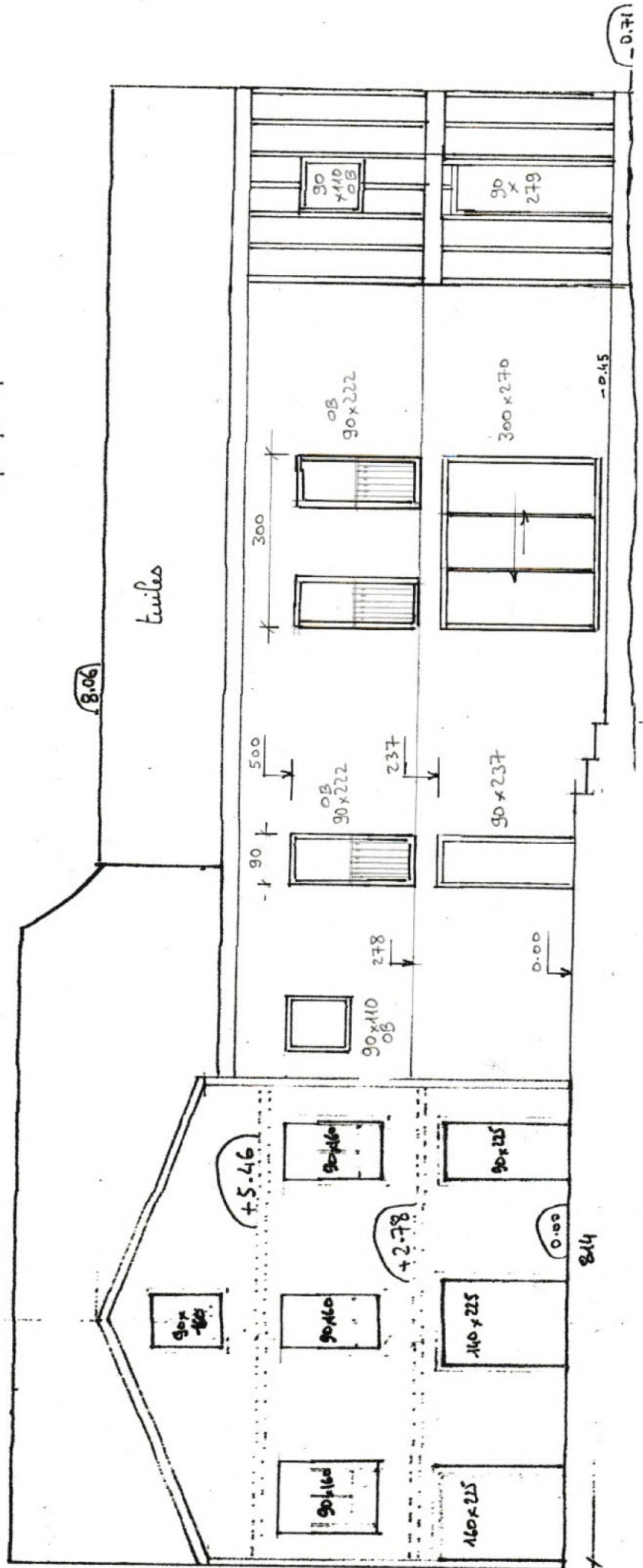

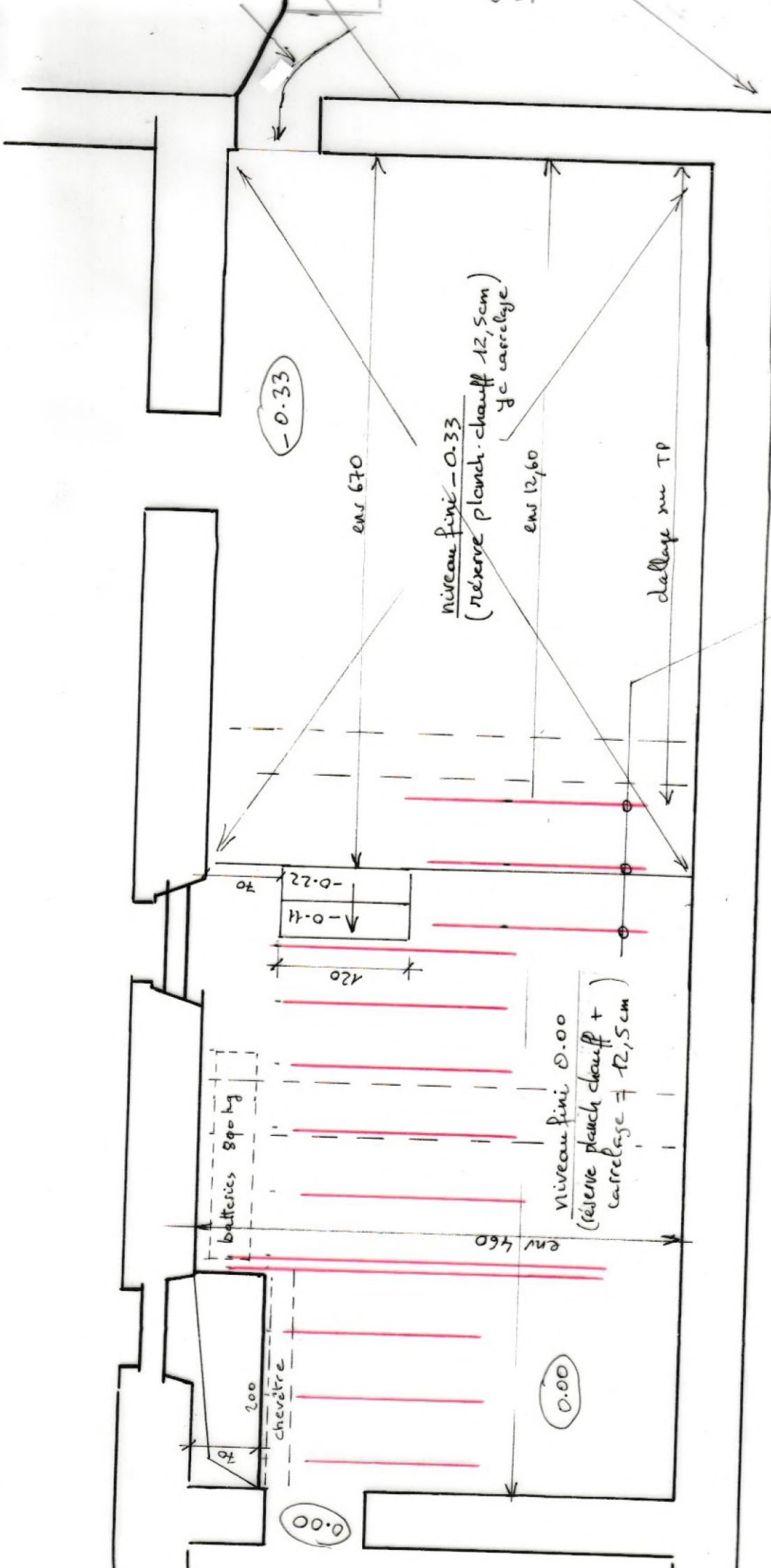

-0.33

ens 670

niveau fini - 0.33
(réserve planch. chauff 12,5cm
+ carrelage)

ens 12,60

dallage sur TP

poutrelles plus basses
(voir coupe)

70

-0.22

-0.14

120

batteries 80x120

200

chevêtre

niveau fini 0.00
(réserve planch chauff +
carrelage = 12,5cm)

ens 460

0.00

0.00

Plancher haut VS - Dallage RC

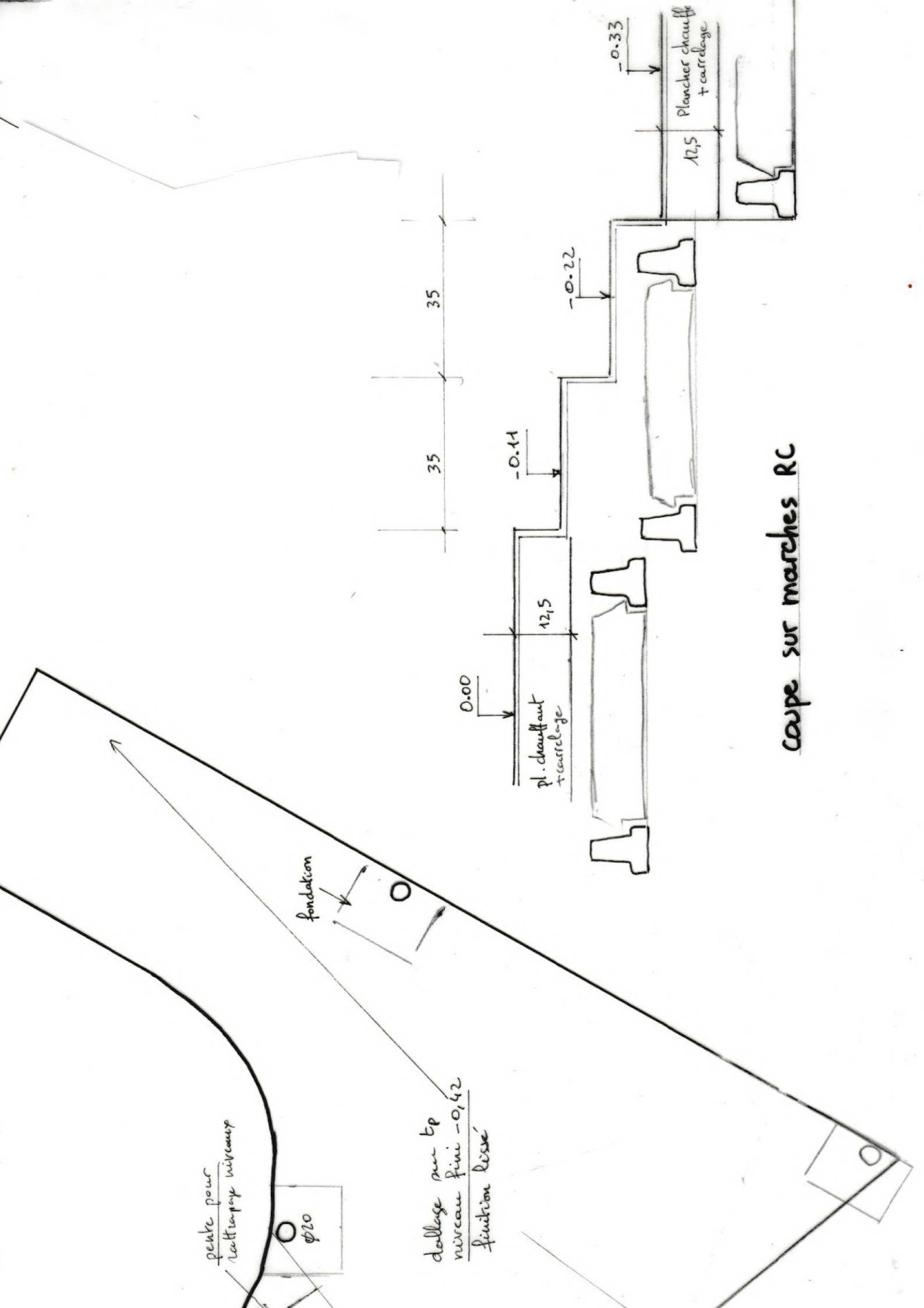

pente pour
rattrapage marches

fondation

dallage sur tp
niveau fini -0,42
fonction lisse

coupe sur marches RC

ch

coulée en place

niveau fini +2.78 d'existant
(sol parquet 14mm collé)

env 12.70

env 4.60

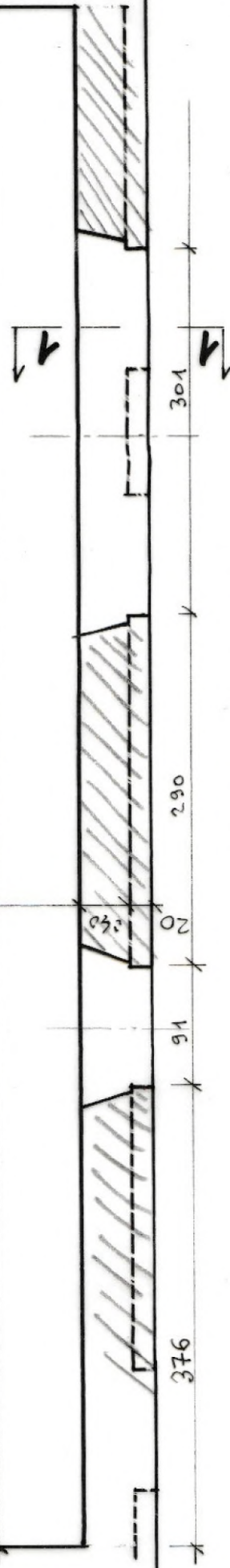
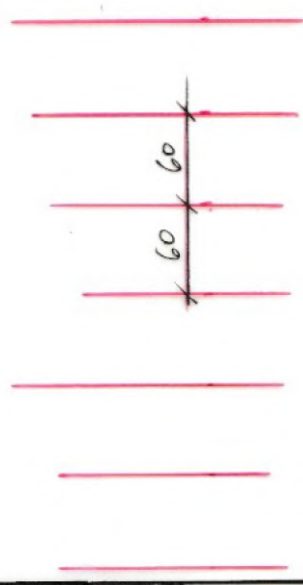

Plancher haut RC

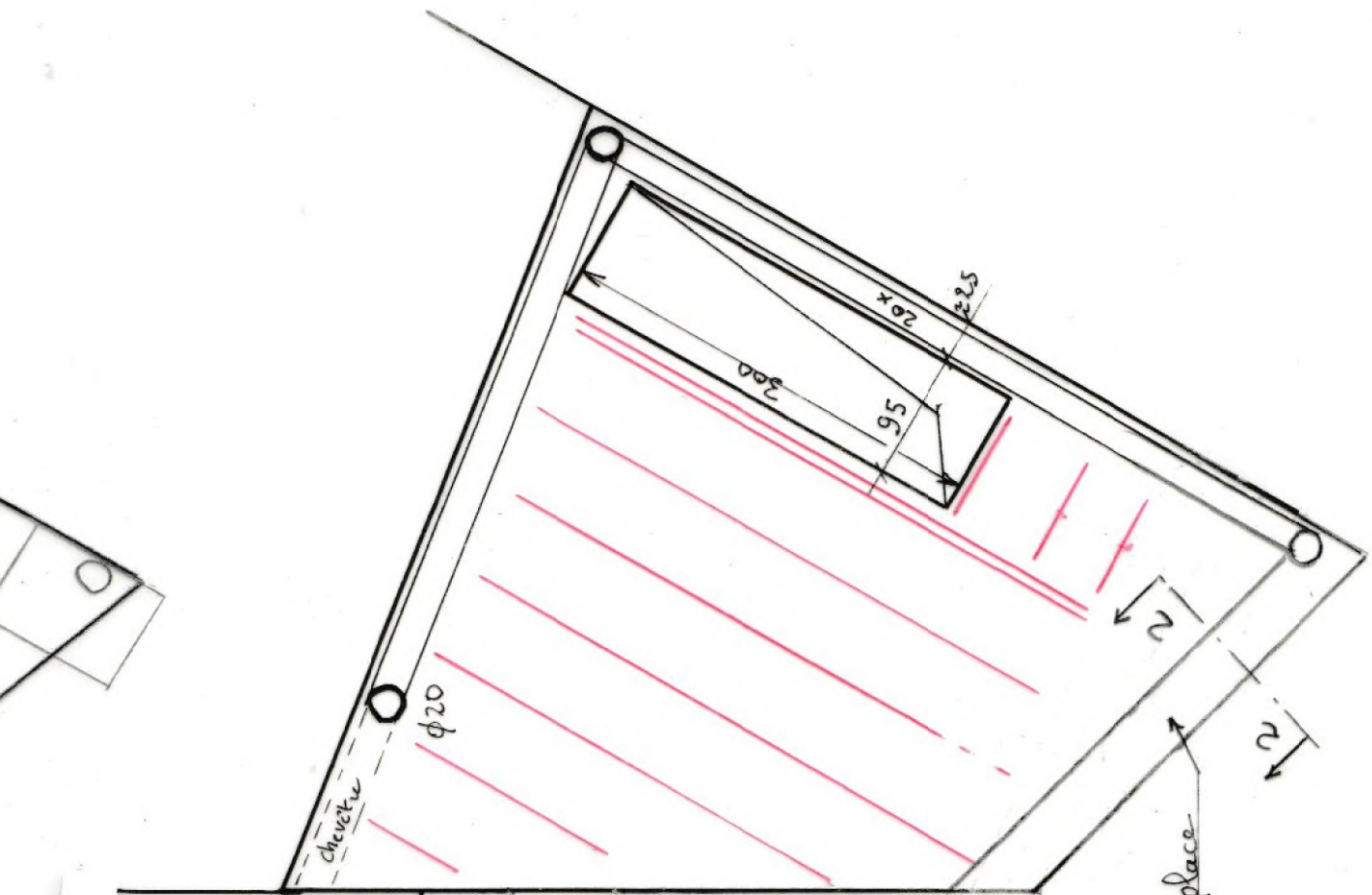

niveau fini + 278 d' existant
 (sol parquet 14mm collé)

enw 12,70

enw 4,60

2,90

3,04

Plancher haut RC

coulée en place

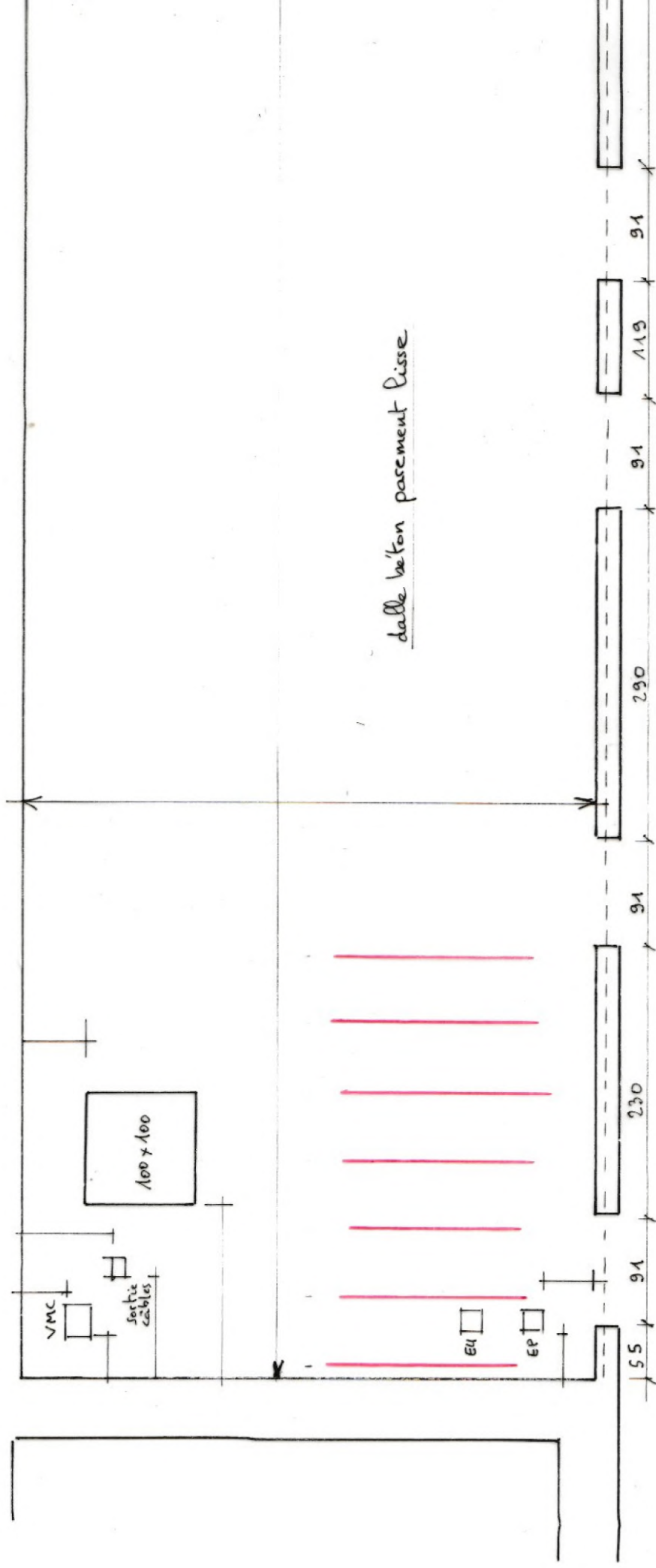

dalle béton parement lisse

plancher haut 1^{er} (dalle terrasse)

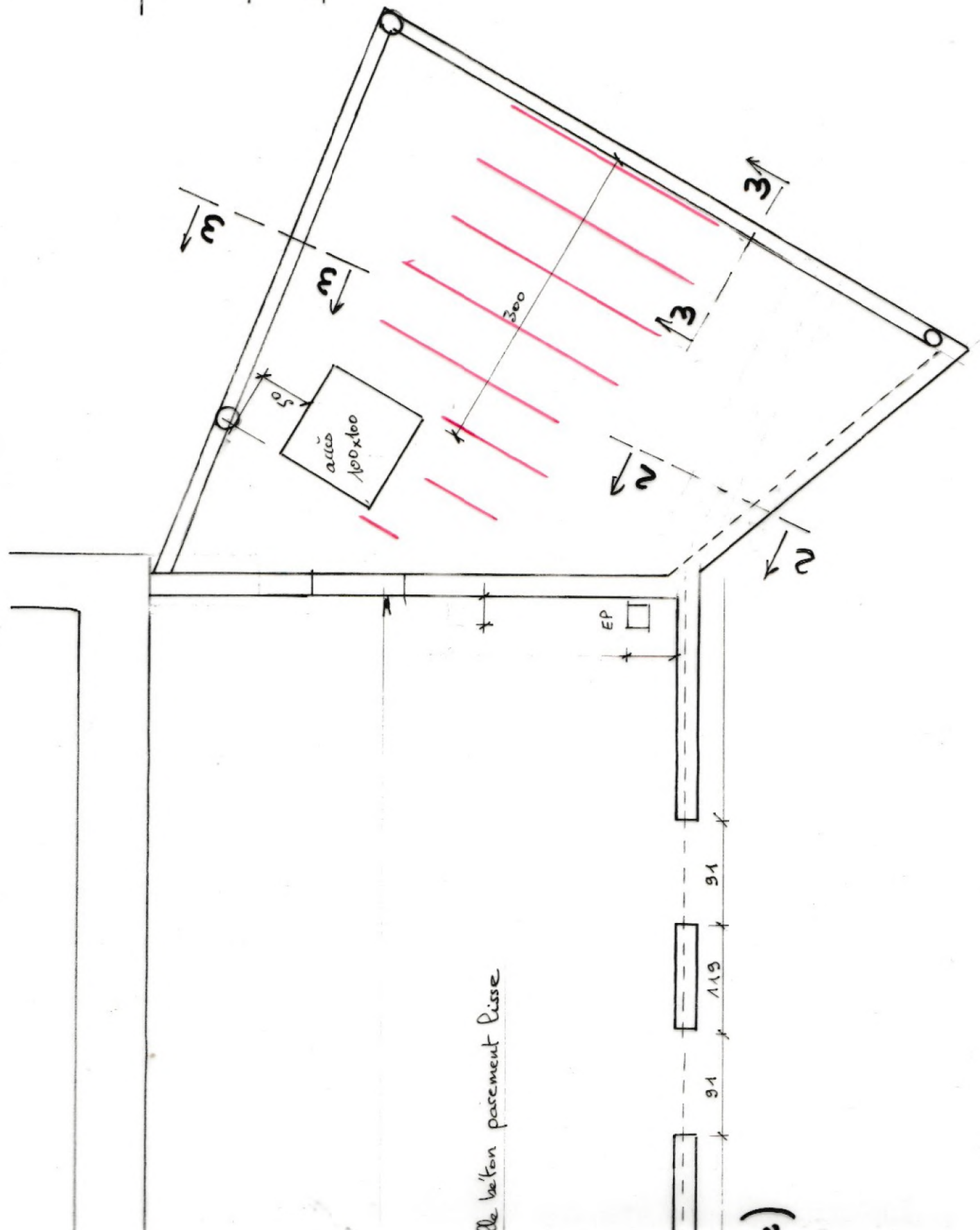
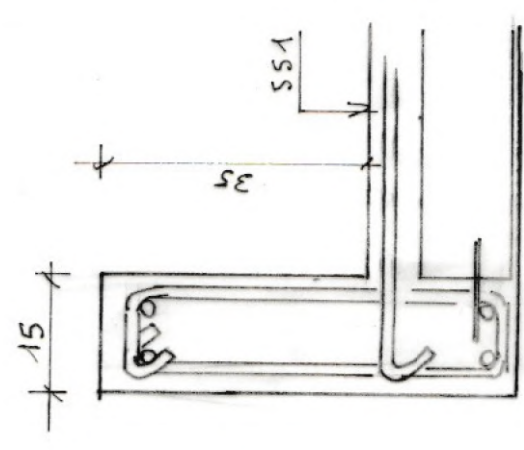
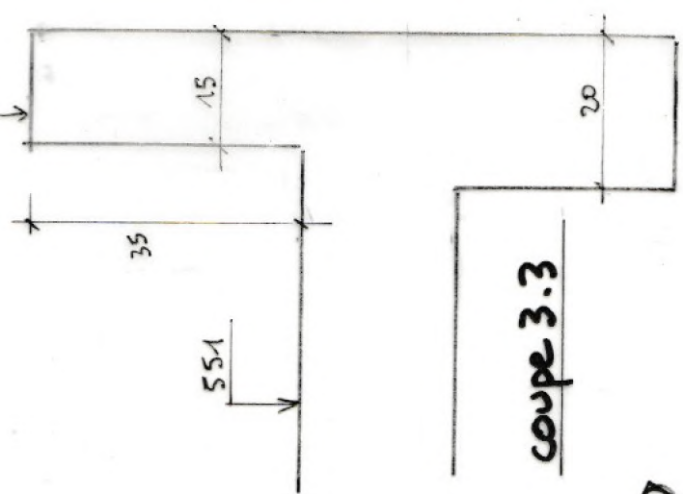

de béton parement lisse

coupe 2.2